

nose section, thick balsa sheet on all sides, shaped to contour, hollowed out if wished.

Prototype model needed nose balast, so hollowing out not really necessary...

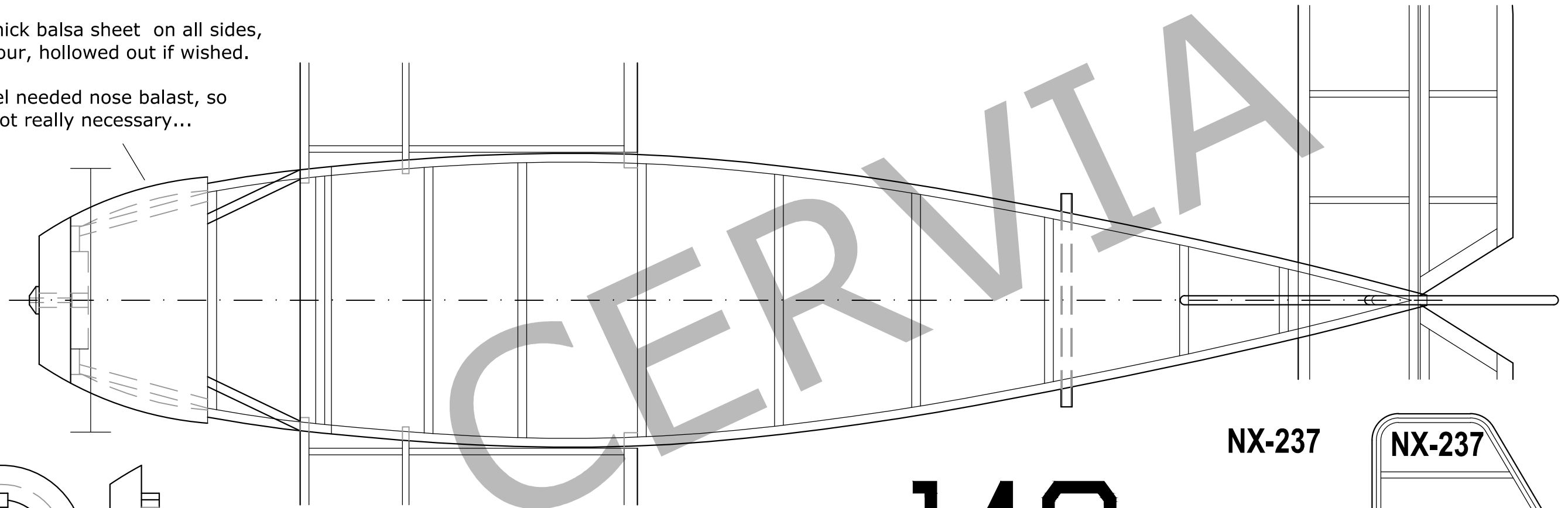

NX-237

NX-237

NEW YORK - Berlin

140

BOSTONIAN AIRCRAFT CORP.

AUSPICIES
BOSTON CHAMBER
OF COMMERCE

BOSTONIAN AIRCRAFT CORP.

nose block + plug,
2° downthrust

Peck nose bearing,
Testors 6" prop

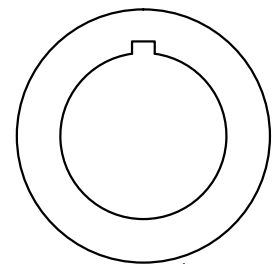

former F1
1,5mm

landing gear leg,
1mm balsa on either
side of wire

secondary landing
gear leg, never
managed to add it to
the prototype...

NEW YORK - Berlin

AUSPICIES
BOSTON CHAMBER
OF COMMERCE

140

"Bellonian" Bostonian

based on the Bellanca WB2, after a failed diet...

George Kandylakis, 28 July 2020

page 1 of 2

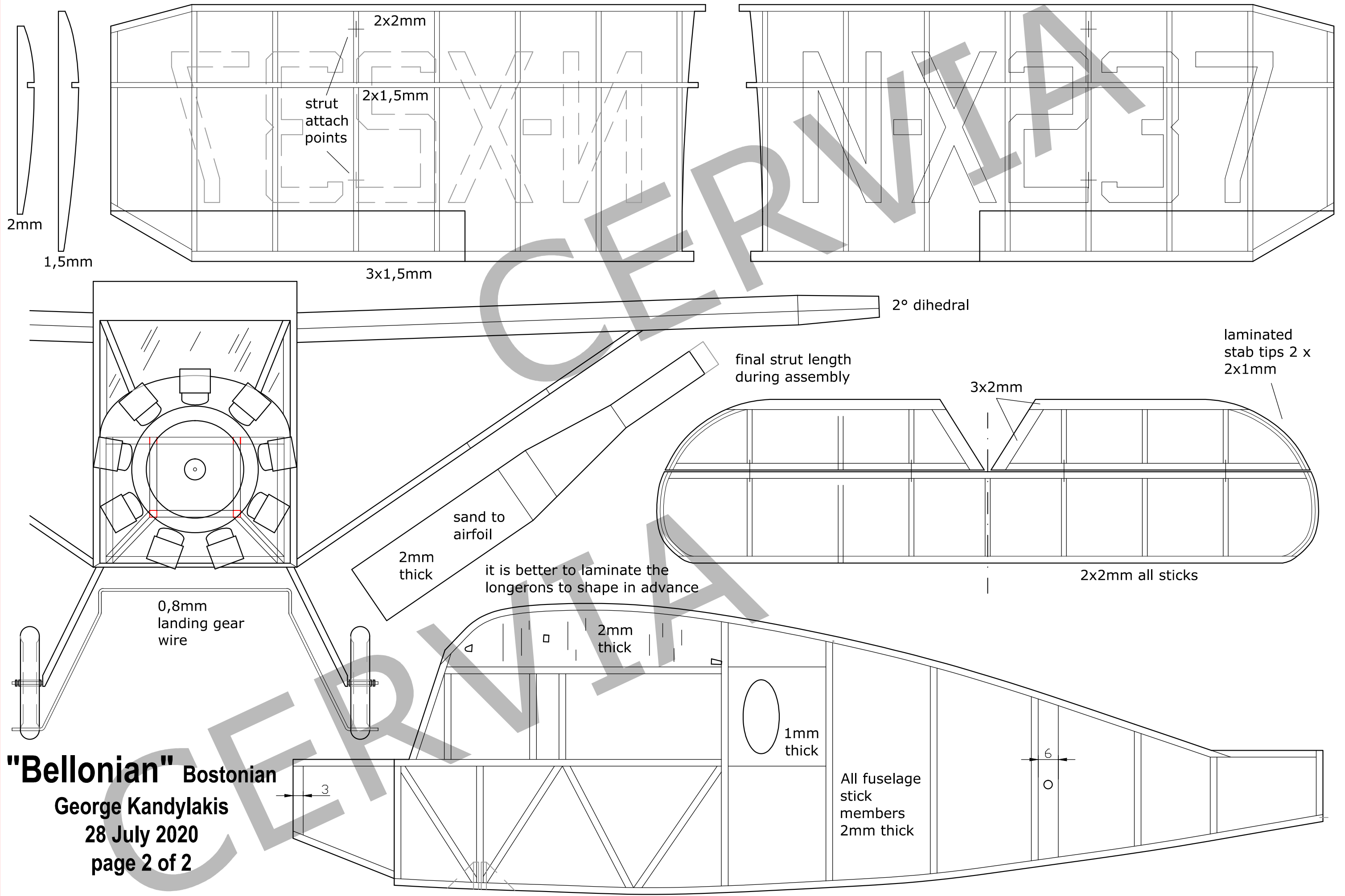

"Bellonian" Bostonian
 George Kandylakis
 28 July 2020
 page 2 of 2